

2 Installing the Pressure Debooster

1. Remove the lower sub from the Pressure Debooster assembly.

Figure 2. Lower sub location

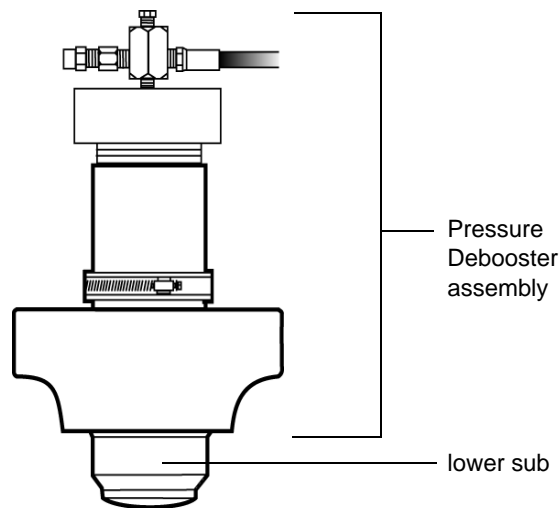

2. Loosen the wing nut, then turn the lower sub to remove the lower sub from the wing nut.

Figure 3. Wing nut and lower sub

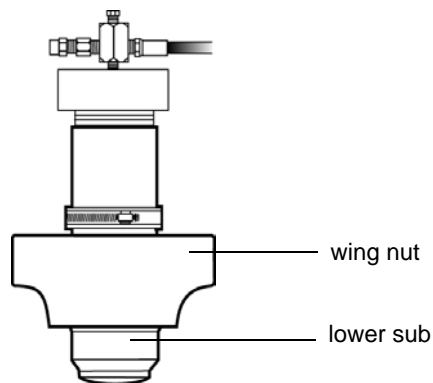

Warning When the lower sub is removed from the assembly, handle the Pressure Debooster with care in order to prevent contamination or damage to the cylinder.

3. Following standard API welding practices, carefully butt-weld the lower sub to the flow line.

Note

The Pressure Debooster must be mounted in a **vertical** position.

4. Use a soft, lint-free cloth to clean the inside of the lower sub.
5. Install the isolator in the lower sub, making sure the isolator is seated properly.

Figure 4. Seating the isolator

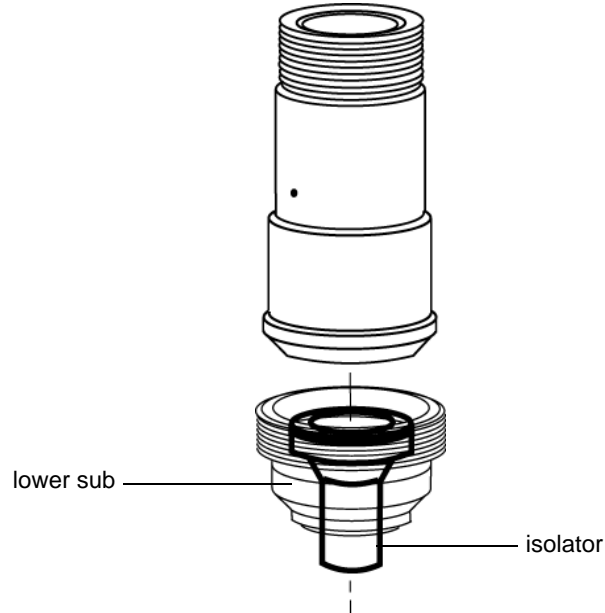

6. Fill the isolator and the lower sub cavity to the brim with A-11 hydraulic fluid.

Note

This step is for charging the Pressure Debooster *only*.

If your Pressure Debooster order included a pressure indicator or recorder, AOI shipped the Pressure Debooster/indicator/recorder system fully charged and it will not require recharging unless the hydraulic connections are loosened or disconnected.

If your order did not include a pressure indicator or recorder, charge the Pressure Debooster system according to the instructions in “Recharging the entire Pressure Debooster system” on page 16.

7. Holding the cylinder/wing nut assembly in a vertical position, engage the wing nut threads, at least one turn, on the lower sub.

Figure 5. Wing nut and lower sub

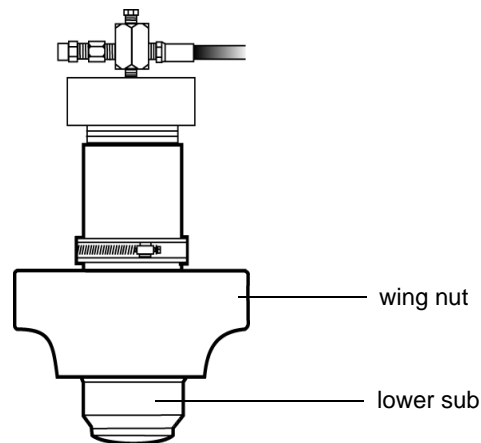

8. Lower the cylinder onto the lower sub and engage the isolator's rubber lip seal.

Figure 6. Cylinder, isolator, and lower sub

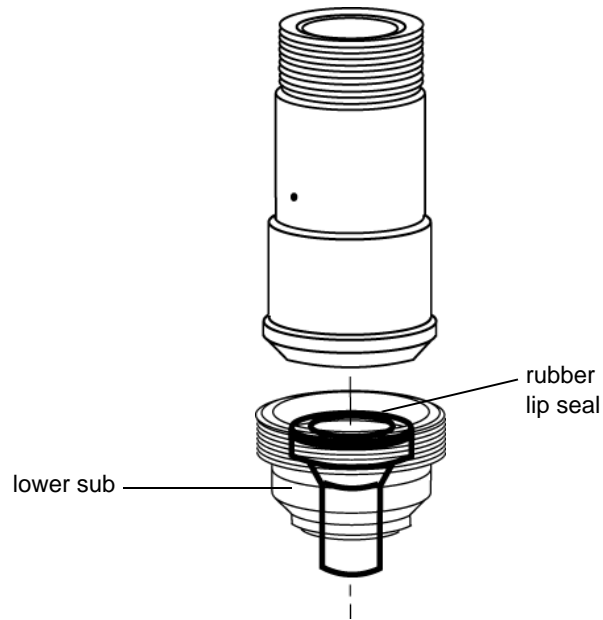

Note

Excessive fluid is displaced from the cavity.

9. Tighten the wing nut.

Installation of the Pressure Debooster is now complete.

Warning Closely observe the Pressure Debooster and all its associated connections the first time you use it to make sure all connections are secure and the system is operating correctly.
